

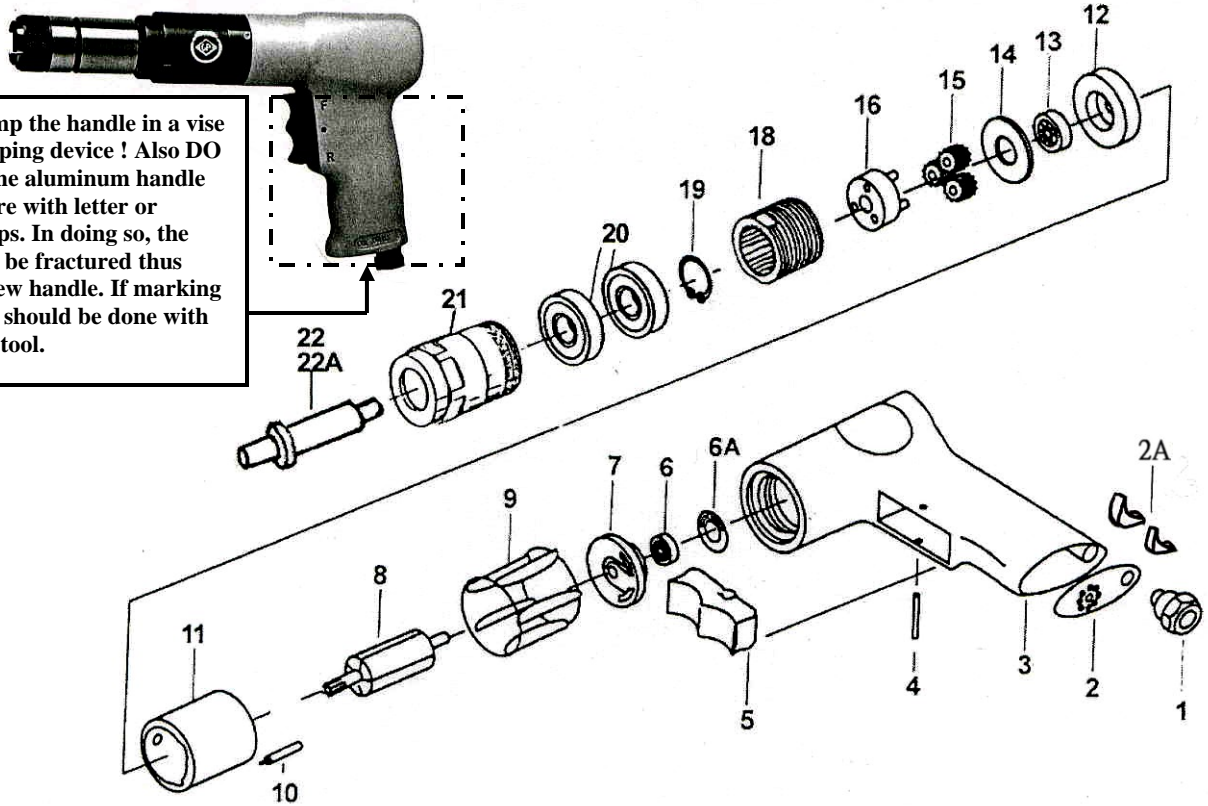

# PT1400P PRO TAPPER

## Wespro Pneumatic Tools

**DO NOT** clamp the handle in a vise or other clamping device ! Also **DO NOT** stamp the aluminum handle body anywhere with letter or number stamps. In doing so, the valve box can be fractured thus requiring a new handle. If marking is required, it should be done with an engraving tool.



\* Handle Assembly 175389  
( Include parts #1, 2, 2A, 3, 4, 5)

| <u>No.</u> | <u>Description</u> | <u>Order Code</u> | <u>Qty</u> | <u>No.</u> | <u>Description</u>  | <u>Order Code</u> | <u>Qty</u> |
|------------|--------------------|-------------------|------------|------------|---------------------|-------------------|------------|
| 1          | Air Inlet          | 148378            | 1          | 11         | Cylinder            | 148551            | 1          |
| 2          | Diffuser Exhaust   | 149200            | 1          | 12         | Front End Plate     | 149255            | 1          |
| 2A         | Silencer           | 179555            | 2          | 13         | Ball Bearing        | 112054            | 1          |
| 3          | Handle             | 175388            | 1          | 14         | Washer              | 149211            | 1          |
| 4          | Pin                | 149202            | 1          | 15         | Planet Gear         | 149286            | 3          |
| 5          | Trigger            | 149204            | 1          | 16         | Gear Cage           | 149287            | 1          |
| 6A         | Gasket             | 188190            | 1          | 18         | Internal Gear       | 149288            | 1          |
| 6          | Ball Bearing       | 112062            | 1          | 19         | Retainer Ring       | 149223            | 1          |
| 7          | Rear End Plate     | 188199            | 1          | 20         | Ball Bearing        | 112043            | 2          |
| 8          | Rotor              | 148548            | 1          | 21         | Nose Housing        | 148549            | 1          |
| 9          | Rotor Blade        | 148546            | 5          | 22         | Drive Spindle (JT1) | 148567            | 1          |
| 10         | Roller Pin         | 149208            | 2          | 22A        | Drive Spindle (B12) | 173060            | 1          |