

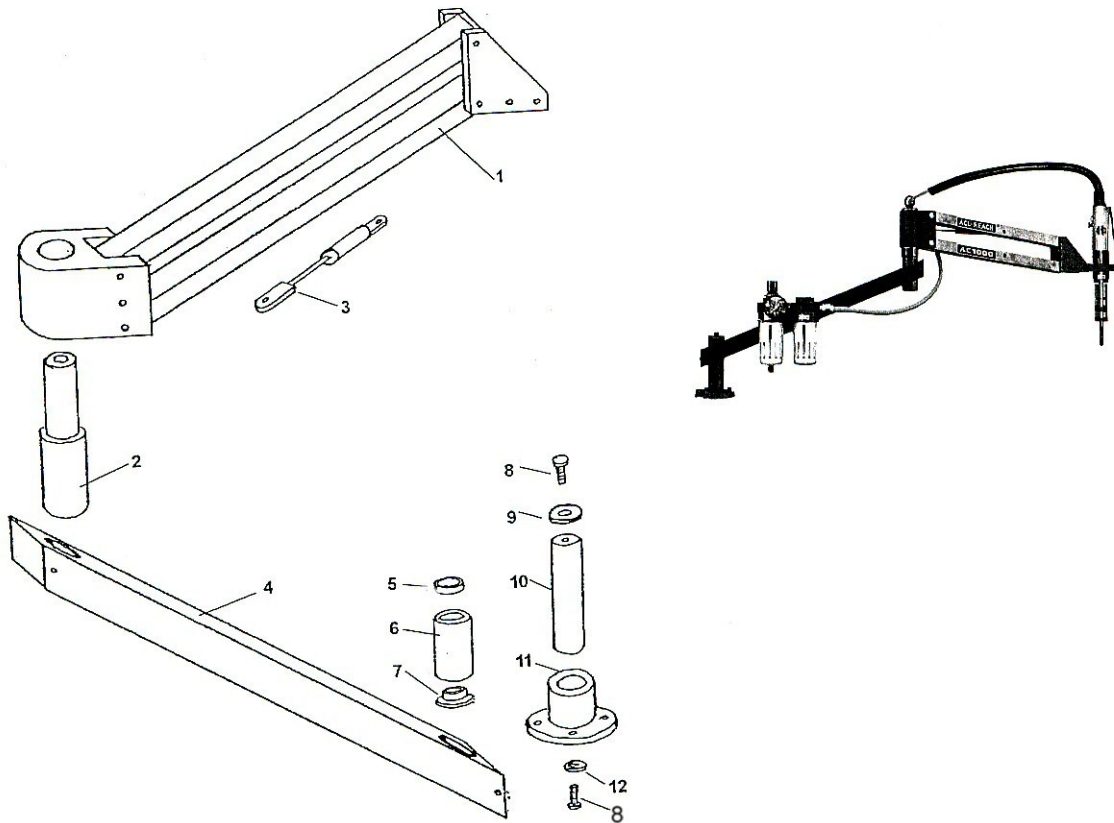

# AC1000 ACU-REACH ARTICULATING BALANCING ARM

## Wespro Pneumatic Tools



<u>No.</u>	<u>Description</u>	<u>Order Code</u>	<u>Qty</u>	<u>No.</u>	<u>Description</u>	<u>Order Code</u>	<u>Qty</u>
1	Tool Arm Ass'y (#3 included)	137770	1	7	Teflon Bushing	147832	1
2	Joining Post	137774	1	8	Socket Head Cap Screw	137777	2
3	Gas Cylinder (400NM)	135928	1	9	Washer	137773	1
4	Jib Arm	137776	1	10	Mounting Post	137779	1
5	Teflon Bushing	137775	1	11	Mounting Base	137780	1
6	Bushing	137772	1	12	Washer	129376	1

### Assembly Instruction:

1. Install the Bushing (#6) into the lower bore of the Lower Arm (#4) and tighten the clamp screw on the arm.
2. Install the bigger end of the Joining Post (#2) into the upper bore of the Lower Arm and tighten the clamp screw on the arm.
3. Adjust two set screws in the Upper Arm (#1) to fix and center the Gas Cylinder (#3).
4. Remove the Cap Screw (#8) & Washer (#9) from the Mounting Post (#10) first. Insert the Mounting Post (#10) and Base (#11) Assembly into the bore of the Bushing (#6). Re-assemble the Washer & Cap Screw back to the Mounting Post.
5. Install the Upper Arm onto the smaller end of the (#2) Joining Post.