



# NOSEPIECE ASSEMBLY FOR PS SERIES (PULL SETTER)

## Wespro Pneumatic Tools

Draw Bolt Nominal Size	Nosepiece Assembly	Nosepiece	Thrust Washer	Thrust Roller Bearing	Rear Thrust Plate	Draw Bolt	Draw Bolt Driver
#4	NPA-#4 C#205376	NP-#4(3mm) C#205363	TW-01 C#143763	TB-01 C#143762	TP-#4(3mm) C#205365	W04040 C#205373	DBD-#4 C#205371
#6	NPA-#6 C#140401	NP-#6 C#148989	TW-01 C#143763	TB-01 C#143762	TP-#6 C#135520	W06032 C#120830	DBD-#6 C#135524
#8	NPA-#8 C#136348	NP-#8(4mm) C#148993	TW-01 C#143763	TB-01 C#143762	TP-#8(4mm) C#135521	W08032 C#125209	DBD-#8 C#148979
#10	NPA-#10 C#136350	NP-#10(5mm) C#148996	TW-01 C#143763	TB-01 C#143762	TP-#10(5mm) C#135522	W10032/W10024 C#120828/125210	DBD-#10(5mm) C#136355
1/4"	NPA-1/4 C#136351	NP-1/4 C#143764	TW-01 C#143763	TB-01 C#143762	TP-1/4(6mm) C#143761	W14020 C#118721	DBD-1/4 C#140876
5/16"	NPA-5/16 C#136352	NP-5/16(8mm) C#143768	TW-01 C#143763	TB-01 C#143762	TW-01 C#143763	W51618 C#125211	DBD-5/16 C#136356
3/8"	NPA-3/8 C#136353	NP-3/8 C#143767	TW-02 C#135555	TB-02 C#134954	TW-02 C#135555	DB-3/8-16 C#135523	DBD-3/8(10mm) C#149007
3 mm	NPA-3mm C#193364	NP-#4(3mm) C#205363	TW-01 C#143763	TB-01 C#143762	TP-#4(3mm) C#205365	DB-3mm C#205369	DBD-3mm C#205370
4mm	NPA-4mm C#136358	NP-#8(4mm) C#148993	TW-01 C#143763	TB-01 C#143762	TP-#8(4mm) C#135521	M04007 C#125216	DBD-4mm C#132866
5mm	NPA-5mm C#136360	NP-#10(5mm) C#148996	TW-01 C#143763	TB-01 C#143762	TP-#10(5mm) C#135522	M05008 C#109913	DBD-#10(5mm) C#136355
6mm	NPA-6mm C#140868	NP-6mm C#198361	TW-01 C#143763	TB-01 C#143762	TP-1/4(6mm) C#143761	M06010 C#124497	DBD-6mm C#143686
8mm	NPA-8mm C#136359	NP-5/16(8mm) C#143768	TW-01 C#143763	TB-01 C#143762	TW-01 C#143763	M08125 C#109912	DBD-8mm C#133514
10mm	NPA-10mm C#132769	NP-10mm C#173522	TW-02 C#135555	TB-02 C#134954	TW-02 C#135555	DB-10mm C#135557	DBD-3/8(10mm) C#149007

Complete nose piece assembly items 1 to 6

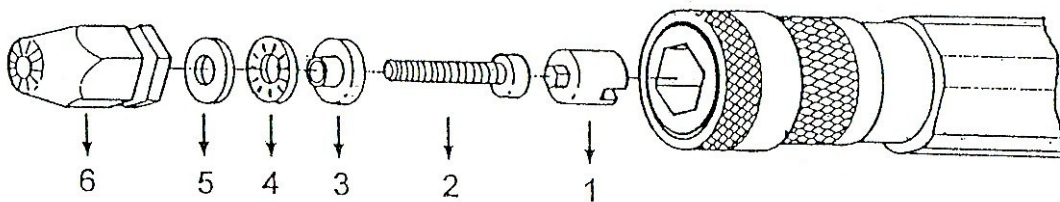

- 6. Nose piece
- 5. Thrust washer
- 4. Thrust roller bearing
- 3. Rear thrust plate
- 2. Draw bolt
- 1. Draw bolt driver

Order by draw bolt size.  
Inches - #4 to 3/8"  
Metric - 3mm to 10mm