

# US-LT20 SERIES SCREW DRIVERS

## EXPLODED VIEW

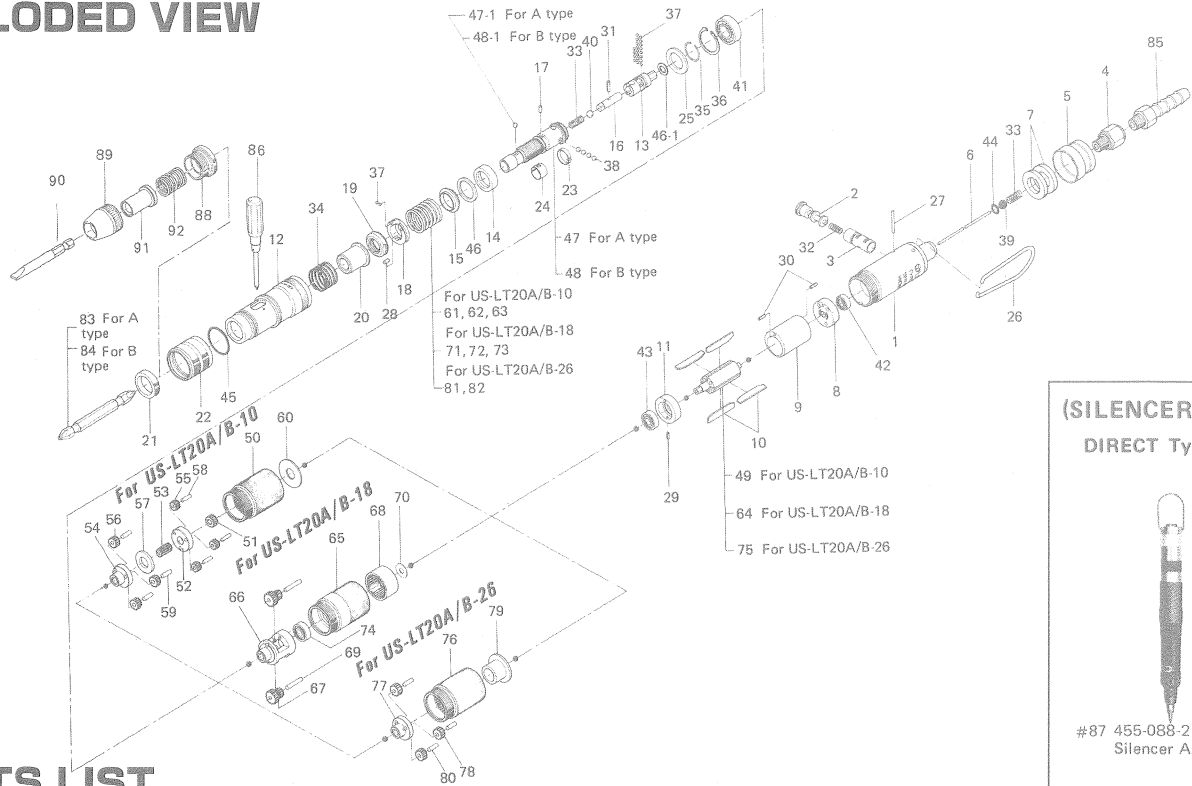

### (SILENCERS) Options DIRECT Type



#87 455-088-2  
Silencer Assembly

## PARTS LIST

Index No.	Code No.	Parts Name	Quantity	Index No.	Code No.	Parts Name	Quantity	Index No.	Code No.	Parts Name	Quantity
<b>Common Parts for US-LT20 series</b>				#38	981-002-0	Ball (1/8)	4	<b>Parts for US-LT20A-18 and US-LT20B-18</b>			
# 1	470-025-8	Casing	1	#39	981-206-0	Ball (1/4)	1	#64	470-287-6	Rotor	1
# 2	893-055-1	Reverse Valve (Lock)	1	#40	981-004-0	Ball (3/16)	1	#65	470-029-6	Gear Casing	1
# 3	470-211-8	Reverse Valve Bushing	1	#41	982-036-0	Ball Bearing (699)	1	#66	470-480-6	Gear Cage	1
# 4	405-091-1	Air Inlet Bushing	1	#42	987-038-0	Miniature Ball Bearing (R-1140ZZ)	1	#67	470-470-6	Planet Gear	2
# 5	455-782-1	Exhaust Deflector	1	#43	987-041-0	Miniature Ball Bearing (R-1350ZZ)	1	#68	470-465-6	Internal Gear	1
# 6	470-104-8	Valve Rod	1	#44	990-903-0	O-Ring (SNS-5)	1	#69	972-037-0	Needle Roller (2.5×15)	2
# 7	470-835-8	Filter	2	#45	990-918-0	O-Ring (SNS-20)	1	#70	975-009-0	Spacer (9×5.2×0.3)	1
# 8	470-285-8	Rear Plate	1	#46	944-014-0	Back-up Ring (P-14)	1	#71	976-431-0	Spring (Standard:18×20)	1
# 9	470-286-8	Cylinder	1	#46-1	470-344-8	Cam Spacer	1	#72	976-432-0	Spring (Strong:18×20)	1
#10	470-288-1	Blade (PC)	4	<b>Parts for US-LT20A series</b>				#73	976-430-0	Spring (Weak:17.5×20)	1
#11	470-289-8	Front Plate	1	#47	470-319-3	Anvil	1	#74	987-013-0	Miniature Ball Bearing (R-1350)1	1
#12	470-369-9	Clutch Casing	1	<b>Parts for US-LT20B series</b>				<b>Parts for US-LT20A-26 and US-LT20B-26</b>			
#13	470-346-8	Cam	1	#47-1	981-155-0	Ball (3.5)	1	#75	470-287-6	Rotor	1
#14	470-375-9	Cam Ring	1	<b>Parts for US-LT20A-10 and US-LT20B-10</b>				#76	470-029-8	Gear Casing	1
#15	470-164-9	Spring Setter	1	#49	470-287-8	Rotor	1	#77	470-480-4	Gear Cage	1
#16	470-318-8	Pilot Pin	1	#50	470-029-8	Gear Casing	1	#78	471-470-3	Planet Gear	3
#17	470-764-8	Notch Pin	1	#51	470-460-8	Rotor Gear	1	#79	470-483-4	Gear Cage Spacer	1
#18	470-562-8	Retainer	1	#52	470-480-8	First Gear Cage	1	#80	972-033-0	Needle Roller (2.5×8)	3
#19	470-257-8	Regulating Screw	1	#53	470-445-8	Middle Gear	1	#81	976-430-0	Spring (Standard:17.5×20)	1
#20	470-351-7	Bit Sleeve	1	#54	470-485-8	Second Gear Cage	1	#82	976-431-0	Spring (Strong:18×20)	1
#21	470-567-7	Bushing	1	#55	470-470-8	First Planet Gear	3	<b>ACCESSORIES</b>			
#22	470-370-8	Clutch Casing Sleeve	1	#56	470-471-8	Second Planet Gear	3	#83	916-710-0	(+)Double Bit (No.2×70) for A-type	1
#23	470-670-8	Band	1	#57	471-483-7	Gear Cage Spacer	1	#84	916-810-0	(+)Double Bit (No.2×75) for B-type	1
#24	470-356-8	Bit Band	1	#58	972-008-0	Needle Roller (2×8)	3	#85	940-103-0	Air Hose Nipple	1
#25	975-153-0	Spacer (21×14.5×1)	1	#59	972-033-0	Needle Roller (2.5×8)	3	#86	939-402-0	Manual Driver No.2 (φ 5)	1
#26	401-790-1	Suspension Ring	1	#60	975-151-0	Spacer (22×8×1.5)	1	<b>For Direct Type</b>			
#27	970-017-0	Pin (H) (1.5×18)	1	#61	976-432-0	Spring (Standard:18×20)	1	#87	455-088-2	Silencer Assembly	1
#28	970-091-0	Pin (H) (2×4.5)	1	#62	976-431-0	Spring (Weaker:18×20)	1	<b>For Slotted Head Bit and Finder</b>			
#29	973-000-0	Roll Pin (1.5×4)	1	#63	976-430-0	Spring (Weakest:17.5×20)	1	#88	470-082-8	Bit Casing Set Screw	1
#30	973-001-0	Roll Pin (1.5×6)	2								
#31	973-003-0	Roll Pin (1.5×8)	1								
#32	976-048-0	Spring (4×10)	1								
#33	976-058-0	Spring (4.5×11)	2								
#34	976-427-0	Spring (17.5×10)	1								
#35	978-150-0	Snap Ring (15×1)	1								
#36	979-320-0	Inner Snap Ring (IRTW-20)	1								
#37	981-000-0	Ball (1/16)	22								

When ordering spare parts, please specify tool type, code number and part name.



**URYU SEISAKU, LTD.** Osaka Japan

For further information, please contact at any time your nearest URYU distributor.

OKA-247-05-07-19-2013