

# US-LD60P series SCREW DRIVERS

## EXPLODED VIEW

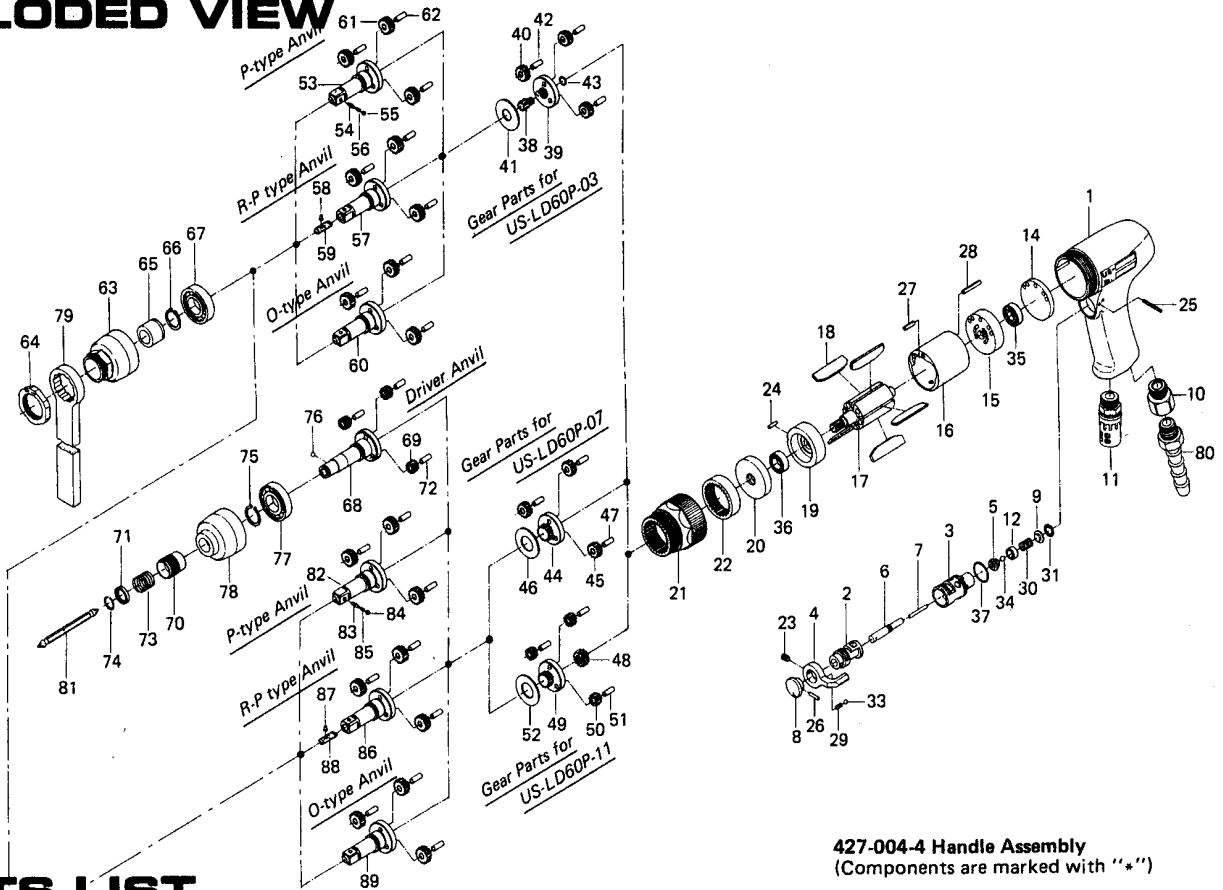

## PARTS LIST

Index No.	Code No.	Part Name	Quantity	Index No.	Code No.	Part Name	Quantity	Index No.	Code No.	Part Name	Quantity
<b>Common Parts for US-LD60P Series</b>				#36	982-100-0	Ball Bearing (6000)	1	#64	427-071-4	Gear Casing Cover Nut	1
# 1	427-025-4	* Handle	1	#37	990-912-0	* O-Ring (SNS-14)	1	#65	499-328-7	Anvil Bushing	1
# 2	480-210-9	* Reverse Valve	1	<b>Gear Parts for US-LD60P-03</b>				#66	979-112-0	Outer Snap Ring (15)	1
# 3	427-211-4	* Reverse Valve Bushing	1	#38	427-445-4	Middle Gear	1	#67	982-102-0	Ball Bearing (6002)	1
# 4	480-212-8	* Reverse Lever	1	#39	427-480-4	Gear Cage	1	<b>Parts for US-LD60P-07 &amp; -11</b>			
# 5	427-100-4	* Valve	1	#40	499-470-7	First Planet Gear	3	#68	427-350-3	Driver Anvil	1
# 6	427-103-5	* Valve Rod Bushing	1	#41	499-483-7	Gear Cage Spacer	1	#69	499-471-3	Second Planet Gear	3
# 7	969-412-0	* Pin (G) (2x12)	1	#42	972-111-0	Roller Pin (4x11)	3	#70	011-352-1	Bit Sleeve	1
# 8	426-107-4	* Throttle Trigger	1	#43	979-347-0	Inner Snap Ring (ISTW-6)	1	#71	011-352-1	Bit Spacer	1
# 9	427-164-4	* Spring Setter	1	<b>Gear Parts for US-LD60P-07</b>				#72	972-110-0	Roller Pin (4x10)	3
#10	191-091-5	* Air Inlet Bushing	1	#44	427-480-3	Gear Cage	1	#73	976-327-0	Spring (13.5x11)	1
#11	499-885-7	* Silencer	1	#45	499-470-7	Planet Gear	3	#74	978-117-0	Snap Ring (11.7x1.0)	1
#12	427-101-4	* Valve Bushing	1	#46	427-483-3	Gear Cage Spacer	1	#75	979-112-0	Outer Snap Ring (15)	1
#14	427-291-4	Rear Plate Spacer	1	#47	972-110-0	Roller Pin (4x10)	3	#76	981-002-0	Ball (1/8)	1
#15	242-285-0	Rear Plate	1	<b>Gear Parts for US-LD60P-11</b>				#77	982-102-0	Ball Bearing (6002)	1
#16	499-286-7	Cylinder	1	#48	499-445-0	Middle Gear	1	#78	426-070-4	Gear Casing Cover	1
#17	427-287-4	Rotor	1	#49	427-480-2	Gear Cage	1	<b>ACCESSORIES</b>			
#18	609-288-1	Blade	5	#50	499-470-0	Planet Gear	3	#79	499-516-7	Reaction Bar	1
#19	499-289-7	Front Plate	1	#51	972-111-0	Roller Pin (4x11)	3	#80	940-114-0	Air Hose Nipple (NPT 1/4x3/8)	1
#20	499-296-7	Front Plate Spacer	1	#52	427-483-3	Gear Cage Spacer	1	#81	916-810-0	(+) Double Bit (No 2x75)	1
#21	427-029-4	Gear Casing	1	<b>Parts for US-LD60P-03</b>				<b>Option for US-LD60P-07 &amp; -11</b>			
#22	427-465-4	Internal Gear	1	<b>Anvils marked with "O" are at user's option.</b>				<b>Anvils marked with "O" are at user's option.</b>			
#23	952-106-0	* Allen Head Dog Point Screw (M4x6)	1	#53	499-319-8	O Anvil (P)	1	#82	499-319-5	O Anvil (P)	1
#24	971-110-0	* Pin (2x10)	1	#54	135-800-1	Socket Retainer Pin	1	#83	135-800-1	Socket Retainer Pin	1
#25	971-123-0	* Pin (2x23)	1	#55	971-202-0	Pin (3x2)	1	#84	971-250-0	Pin (3.3x2)	1
#26	973-014-0	Roll Pin (2x14)	1	#56	976-018-0	Spring (2.8x8.5)	1	#85	976-018-0	Spring (2.8x8.5)	1
#27	973-112-0	Roll Pin (3x12)	1	#57	893-050-1	O Anvil (R-P)	1	#86	893-050-1	O Anvil (R-P)	1
#28	973-122-0	Roll Pin (3x22)	1	#58	891-105-1	Socket Retainer Pin	1	#87	891-105-1	Socket Retainer Pin	1
#29	976-006-0	* Spring (3x5)	1	#59	891-106-1	Socket Retainer Pin	1	#88	891-106-1	Socket Retainer Pin	1
#30	976-942-0	* Spring (7.5x12)	1	#60	499-319-7	O Anvil (O)	1	#89	499-319-4	O Anvil (O)	1
#31	979-004-0	* Inner Snap Ring (11)	1	#61	499-471-7	Second Planet Gear	3	[Use the above parts (#61-#67) in common]			
#32	979-401-0	* Outer Snap Ring (E1.5)	1	#62	972-111-0	Roller Pin (4x11)	3				
#33	981-002-0	* Ball (1/8)	1	#63	427-070-4	Gear Casing Cover	1				
#34	981-003-0	* Ball (5/32)	1								
#35	982-035-0	Ball Bearing (698)	1								

When ordering spare parts, please specify tool type, code number and part name.

Printed in Japan

**URYU SEISAKU, LTD.** Osaka, Japan